

L23/30H

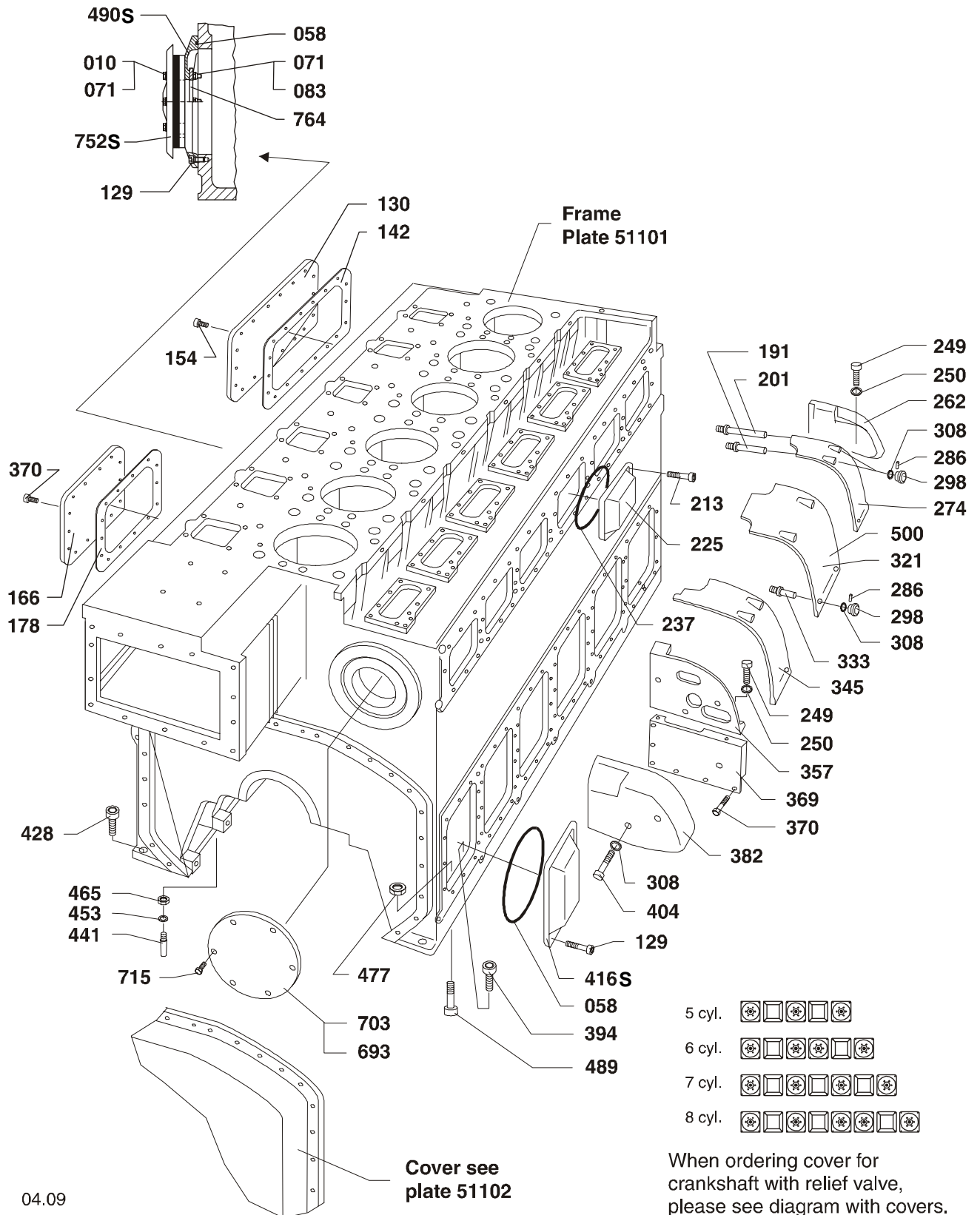

08028-0D/H5250/94.08.12

04.09

L23/30H

Item No	Qty.	Designation	Benævnelse	Item No	Qty.	Designation	Benævnelse
010	6/D	Screw	Skrue	298		Handle	Håndtag
058	2/C	O-ring	O-ring	22/E		5 cyl. engine	5 cyl. motor
071	12/D	Washer	Skive	26/E		6 cyl. engine	6 cyl. motor
083	6/D	Self locking nut	Selvlåsende møtrik	30/E		7 cyl. engine	7 cyl. motor
129	8/C	Screw	Skrue	34/E		8 cyl. engine	8 cyl. motor
130		Cover	Dæksel	308		Washer	Skive
	2/E	5 cyl. engine	5 cyl. motor	24/E		5 cyl. engine	5 cyl. motor
	3/E	6 cyl. engine	6 cyl. motor	28/E		6 cyl. engine	6 cyl. motor
	3/E	7 cyl. engine	7 cyl. motor	32/E		7 cyl. engine	7 cyl. motor
	4/E	8 cyl. engine	8 cyl. motor	36/E		8 cyl. engine	8 cyl. motor
142		Gasket	Pakning	321		Guard intermediate	Mellemskærm
	2/E	5 cyl. engine	5 cyl. motor	4/E		5 cyl. engine	5 cyl. motor
	3/E	6 cyl. engine	6 cyl. motor	5/E		6 cyl. engine	6 cyl. motor
	3/E	7 cyl. engine	7 cyl. motor	6/E		7 cyl. engine	7 cyl. motor
	4/E	8 cyl. engine	8 cyl. motor	7/E		8 cyl. engine	8 cyl. motor
154		Screw	Skrue	333	2/C	Stud	Tap
	58/E	5 cyl. engine	5 cyl. motor	345	1/E	Guard end fore	Skærm, for
	66/E	6 cyl. engine	6 cyl. motor	357	1/E	Guard end fore	Skærm, for
	80/E	7 cyl. engine	7 cyl. motor	369	1/E	Guard	Skærm
	88/E	8 cyl. engine	8 cyl. motor	370	14/E	Screw	Skrue
166	1/E	Cover	Dæksel	382	1/E	Guard end fore	Skærm, for
178	1/E	Gasket	Pakning	394	6/C	Screw	Skrue
191	2/C	Stud	Tap			only for 900 rpm	kun for 900 omdr.
201	2/E	Stud	Tap	404	2/E	Screw	Skrue
213	4/C	Screw	Skrue	416S		Cover for crankcase	Dæksel for krumtaphus
225	1/C	Cover for camshaft housing	Dæksel for kamakselhus	7/E		5 cyl. engine	5 cyl. motor
237	1/C	O-ring	O-ring	8/E		6 cyl. engine	6 cyl. motor
249	5/E	Screw	Skrue	10/E		7 cyl. engine	7 cyl. motor
250	5/E	Washer	Skive	11/E		8 cyl. engine	8 cyl. motor
262	1/E	Guard end aft	Skærm, agter	428	4/E	Screw	Skrue
274	1/E	Guard end aft	Skærm, agter	441	2/E	Tapered dowel	Styrestift
286		Spring pin	Fjederstift	453	2/E	Washer	Skive
	22/E	5 cyl. engine	5 cyl. motor	465	2/E	Nut	Møtrik
	26/E	6 cyl. engine	6 cyl. motor	477	6/C	Nut	Møtrik
	30/E	7 cyl. engine	7 cyl. motor			only for 720/750 rpm	kun for 720/750 omdr.
	34/E	8 cyl. engine	8 cyl. motor	489	6/C	Screw	Skrue
						only for 720/750 rpm	kun for 720/750 omdr.

When ordering spare parts, see also page 500.50.

Ved bestilling af reservedele, se også side 500.50.

* = Only available as part of a spare parts kit.
 Qty./E = Qty./Engine
 Qty./C = Qty./Cylinder
 Qty./D = Qty./Safety cover

* = Kun tilgængelig som en del af et reservedelssæt.
 Antal/E = Antal/Motor
 Antal/C = Antal/Cylinder
 Antal/D = Antal/sikkerhedsdæksel