

Food waste disposers, 500 series



- REMOVE FOOD WASTE QUICKLY AND HYGIENICALLY BY WET GRINDING
- LARGE CAPACITY DISPOSER FOR NEW AND EXISTING SINKS / WORK TOPS
- WELL PROVEN DESIGN GIVES RELIABLE OPERATION
- EASY TO OPERATE, CLEAN AND MAINTAIN
- COMPLIES WITH IMO / MARPOL REGULATIONS FOR WASTE HANDLING AT SEA

This series of heavy duty galley disposers will meet the requirement of efficient and hygienic disposal of both preparation and table food waste.

The wide range of models enables a choice of disposers powerful enough to handle any volume and particular type of food waste. The many assemblies provides the means to install the disposer in any new or existing sink unit, working top or as a free standing unit.

The grinding unit, manufactured in a special cast steel alloy has proven over many years to give little wear. The unique long-life shaft seal design in the grinding unit combined with a water tight motor ensures low maintenance costs with years of trouble free service. In addition the 500-serie disposers have a high quality stainless steel casing with smooth surface for best possible corrosion resistance and hygiene.

500-serie disposers are delivered with 2 m electrical cord.

For further specifications of the different models, please see overleaf.

LOIPART AB

P.O. Box 694
SE 441 18 Alingsås, Sweden
Phone +46 322 66 83 60
Telefax +46 322 63 77 47
E-mail loipart@loipart.se

Exclusive Sales of
Electrolux Marine Equipment

18-403

DOC.NO. 18-403BM
EDITION 6 04.07

FOOD WASTE DISPOSERS, 500 SERIES

Dimensions mm

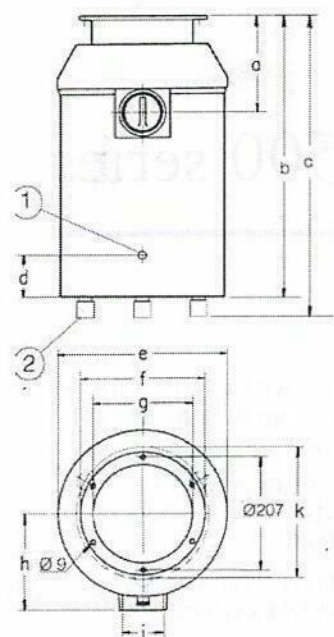

1. Power cable outlet, 2 m cord incl.
2. Supporting legs (3pcs),
- models 520, 530, 550, 575 only

Contactor, motor protector, solenoid valve with filter and jam release wrench (3) are included in delivery.

Dimensions mm

Type	a	b	c	d	e	f	g	h	i	k
510	151	419	without legs**	40	253	225	165	150	2" BSP Female	-
515		481	501-707							
520	173	541*	571-616	75	309	180	176	2 1/2" BSP Female	236	
530		633	663-708							
550										
575										

* Shorten version 503 mm available upon request

** Legs available upon request (with same measurements b, c, k as for model 520)

Specifications

Model	Type	Capacity kg/h	Voltage V*	Loading kW	Rated current, A	Fuse, slow, A	Weight kgs		Shipping volume m ³
							net	gross	
510 50	510	300	400 3-50	0.75	2.1	10	26	29	0.100
510 60			440 3-60						
515 50	515	400	400 3-50	1.1	2.6	10	27	30	
515 60			440 3-60				2.4		
520 50	520	500	400 3-50	1.5	3.4	16	31	34	
520 60			440 3-60				3.5		
530 50	530	700	400 3-50	2.2	5.2	16	44	47	
530 60			440 3-60						
550 50	550	850	400 3-50	4.0	9.0	16	51	54	
550 60			440 3-60				7.5		
575 50	575	1000	400 3-50	5.5	11.5	25	60	63	
575 60			440 3-60				11.6		

* other voltages available on request

Optional assemblies and accessories

Model	Description
16 98 18*	Marine inst. Ø 170 mm opening, DRR-K
16 98 19	Main switch
16 98 34*	Marine inst. Ø 80 mm opening, ATF
16 98 36*	Marine inst. Ø 80 mm opening, BS
16 98 37	Marine inst. for working tops, HK for continuous feeding
16 98 38	Marine inst. for working tops, MI for batch feeding
16 98 56	Flush pipe, option to nozzle
16 98 57	Ball valve, to shut-off sink
TIM 00	Timer type TIM-00-01-01, for automatic control of disposer and water flushing.
919006	Water trap 2" for models 510, 515, 520
919007	Water trap 2 1/2" for models 530, 550, 575
902800	Securing bar
903600	Solenoid valve

* For sinks and washing lines, continuous feeding

ATF, and BS type of installation have to be fixed against bulkhead (11).

HK and MI type of installations can be installed in a table or working top.

General installation

Water supply to be with 1/2" reinforced flexible hose from the incoming water pipe in order to absorb small vibrations and the compressive push when the flushing water is turned on. Disposer legs to be adjusted for support. The slope (f) must not be less than 2:100 preferably 5:100. Water trap (12, optional extra) and sewer bends to be curved gradually, (d₁) approximately 50 mm deep and (k) to be 150-200 mm, (n) to be at least equal to the inner water trap diameter.

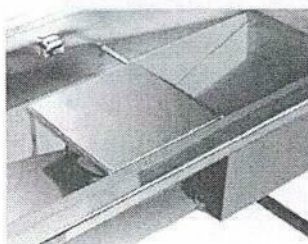

Model 16 98 18



Model 16 98 34



Model 16 98 36

views from above:



Model 16 98 37 (HK)

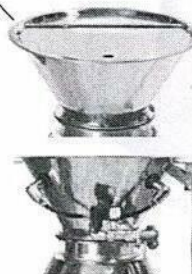

Model 16 98 38 (MI)

Model 902800

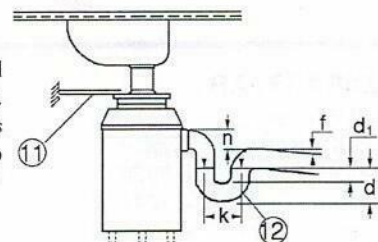
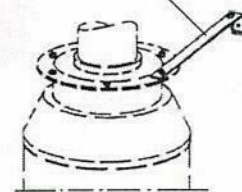

FOOD WASTE DISPOSERS, 500-SERIES BS-MODELS

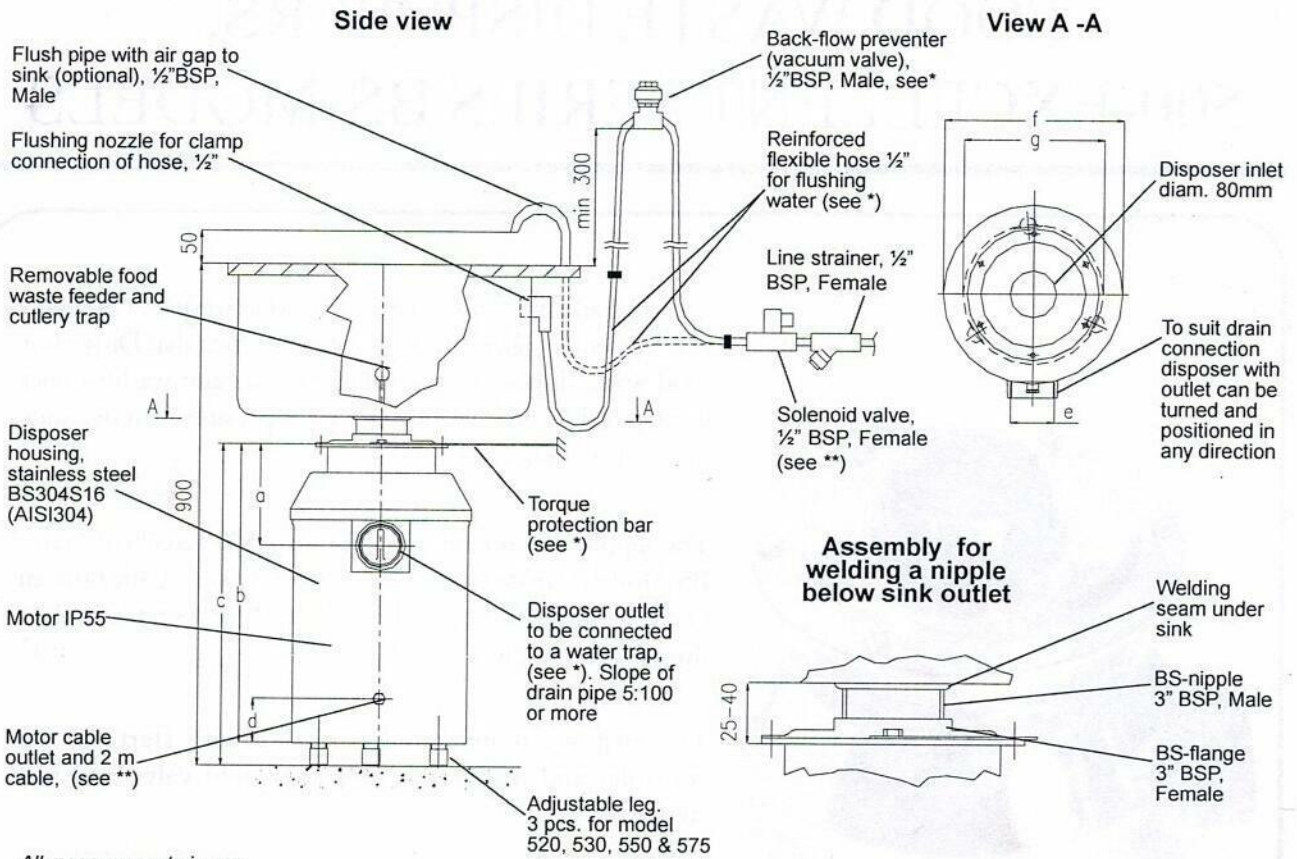

All measurements in mm

Technical Specification	510-BS	515-BS	520-BS	530-BS	550-BS	575-BS
Normal capacity, kg/hr	300	400	500	700	850	1000
Electrical power, kW	0,75	1,1	1,5	2,2	4,0	5,5
Rated current, A for:						
230 V / 3 ph. / 50 Hz	3,5	5,6	5,8	8,8	15,8	20,7
400 V / 3 ph. / 50 Hz	2,0	3,2	3,3	5,1	9,1	11,9
440 V / 3 ph. / 60 Hz	2,1	2,6	3,5	5,2	9,0	12,3
Other voltages available						
Control voltage	For marine installation the same as motor voltage. For land installation 230V / 50HZ					
Fuse rating, slow	10 A	10 A	10 A	16 A	16 A	25 A
Gross / net weight, kg	30 / 27	32 / 29	36 / 33	48 / 45	55 / 52	65 / 62
Measurement a	151	151	151	173	173	173
Measurement b	419	419	481	541, see****	541, see****	633
Measurement c	See***	See***	501-707	571-616	571-616	663-708
Measurement d	40	40	40	75	75	75
Measurement e	2"	B S P,	F e m a l e	2 1/2"	B S P,	F e m a l e
Measurement f	253	253	253	309	309	309
Measurement g (legs)	See***	See***	210	236	236	236

* Installation material needed but not incl. in standard delivery are electrical connection terminal / main switch, flexible hose 1/2", back-flow preventer, water trap and torque protection bar. Can be ordered from DISPERATOR.

** For connection to start & stop controller (IP55, incl. overload protector) placed on wall / bulkhead. Controller to be connected to terminal / main switch (see*).

*** As standard without legs. Legs available as option - and then with same measurement b), c) and g) as for model 520.

**** Short version (where b = 503 mm) available as option.

***** Installation, operation and service instructions are together with this product leaflet included in delivery.