

**INTRINSICALLY SAFETY**

[ MODEL: ATM / Ex ]

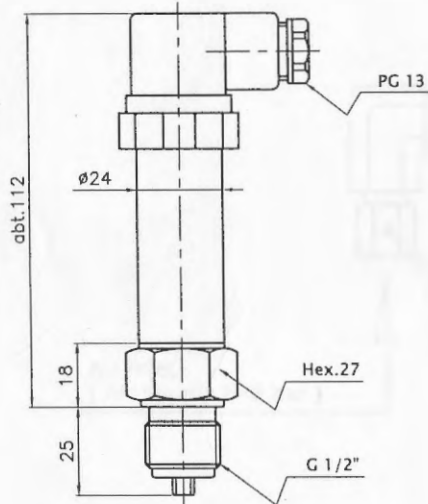
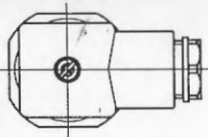

\*Piezoresistive measuring element -

\*Body material : Stainless steel 1.4435(316L)

**ELECTRICAL CONNECTION**

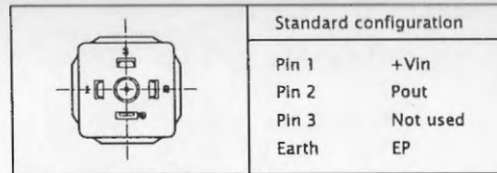

**LOAD RESISTANCE**

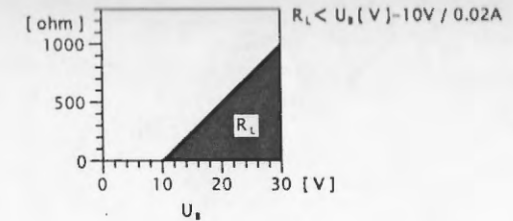

**TECHNICAL DATA**

Power source	DC 10 - 30V [ Reverse polarity and short circuit protected ]
Output	4 ... 20mA ( Two wire current transmitter )
Accuracy	≤ 0.25% of F.S
Response time	< 1ms / 10 ... 90% F.S
Thermal shift	Zero ≤ ±0.08% F.S, -25 ... 85°C Span ≤ ±0.02% F.S, -25 ... 85°C
Long term stability ( 1 year )	< 0.5% FS / < 4mbar
Measurement Range	-1 ... 0.6bar(HIGH : 0.125bar, LOW : 0.01bar) ✓
Max. Overpressure	3bar
Burst pressure	> 200bar
Ambient temperature ( Ta )	-25 ... 85°C ( T4 )
Process temperature	-25 ... 100°C
Type of protection	II 1 G EEx ia IIC T4
Certificate Number	KEMA 03ATEX 1127
Protection Rating	IP65(DIN connector)

NO.	DESCRIPTION			Q'TY	MAT'L	REMARK
SCALE	ANGLE	UNIT	DATE	DRAWN	CHK'D	APP'D
N/S	3rd	mm	2008.05.20	Y.C.KWON	S.K.LEE	T.S.PYO
PROJECT			TITLE			
0307348/349/358 /359/360/361			PRESSURE TRANSMITTER [ MODEL: ATM / Ex ]			